

Proposed General Arrangement Plan
Lower Ground Floor
Desk 1200mm x 800mm

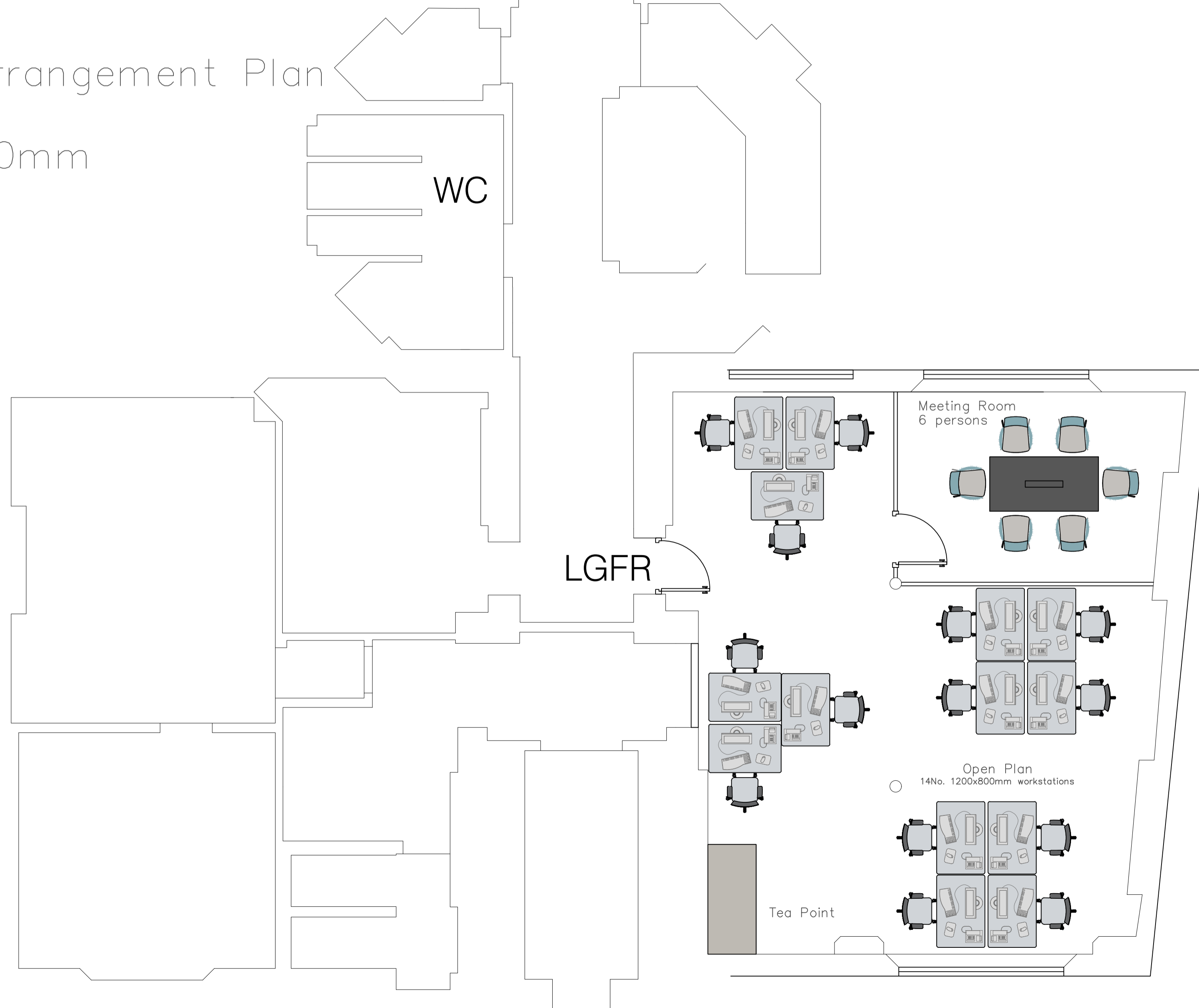

NOTE: STOCK PROJECT
THIS ELECTRONIC INFORMATION IS
CONFIDENTIAL AND THE COPY OF
STOCK PROJECTS, NO USE IS
PERMITTED OF IT OTHER THAN
BY THE INTENDED RECIPIENT FOR
PROPER PURPOSE NOR
SHALL IT BE DISCLOSED OR
PASSED ON TO ANY
OTHER PARTY IN ANY FORM IN
WHOLE OR IN PART
WITHOUT OUR EXPRESS
PERMISSION.
THE DATA IS SUPPLIED
ELECTRONICALLY FOR
CONVENIENCE ONLY. THE ORIGINAL
INFORMATION IS THE HARD COPY
WHICH WILL BE SUPPLIED ON
REQUEST.
NO DIMENSIONS OR OTHER
INFORMATION SHOULD BE INFERRED
FROM THE ELECTRONIC DATA
UNLESS SPECIFICALLY SHOWN ON
THE HARD
COPY. WE ACCEPT NO LIABILITY
FOR ANY EFFECT THAT THE
TRANSMISSION OR USE OF THIS
DATA MAY HAVE ON ANY
COMPUTER OR SYSTEM WHETHER IN
RELATION TO ANY DEFECT, VIRUS
OR ANY OTHER MATTER. YOUR
RECEIPT OF THIS INFORMATION
AND OPENING OF THE FILES
CONSTITUTES ACCEPTANCE OF
THESE TERMS.

— Proposed layout 11.06.26
Rev: | Description Date

PROPOSED

Address:
6 Lloyds Avenue
London

Project:
Private Client

Drawing title:
Lower Ground Floor - 01

Scale: 1:50 @A3
Project No: 00004
Drawing No: 004.00.01



NOTE: STOCK PROJECT
 THIS ELECTRONIC INFORMATION IS
 CONFIDENTIAL AND THE COPY OF
 STOCK PROJECTS, NO USE IS
 PERMITTED OF IT OTHER THAN
 BY THE INTENDED RECIPIENT FOR
 PROPER PURPOSE NOR
 SHALL IT BE DISCLOSED OR
 PASSED ON TO ANY
 OTHER PARTY IN ANY FORM IN
 WHOLE OR IN PART
 WITHOUT OUR EXPRESS
 PERMISSION.
 THE DATA IS SUPPLIED
 ELECTRONICALLY FOR
 CONVENIENCE ONLY. THE ORIGINAL
 INFORMATION IS THE HARD COPY
 WHICH WILL BE SUPPLIED ON
 REQUEST.
 NO DIMENSIONS OR OTHER
 INFORMATION SHOULD BE INFERRED
 FROM THE ELECTRONIC DATA
 UNLESS SPECIFICALLY SHOWN ON
 THE HARD
 COPY. WE ACCEPT NO LIABILITY
 FOR ANY EFFECT THAT THE
 TRANSMISSION OR USE OF THIS
 DATA MAY HAVE ON ANY
 COMPUTER OR SYSTEM WHETHER IN
 RELATION TO ANY DEFECT, VIRUS
 OR ANY OTHER MATTER. YOUR
 RECEIPT OF THIS INFORMATION
 AND OPENING OF THE FILES
 CONSTITUTES ACCEPTANCE OF
 THESE TERMS.

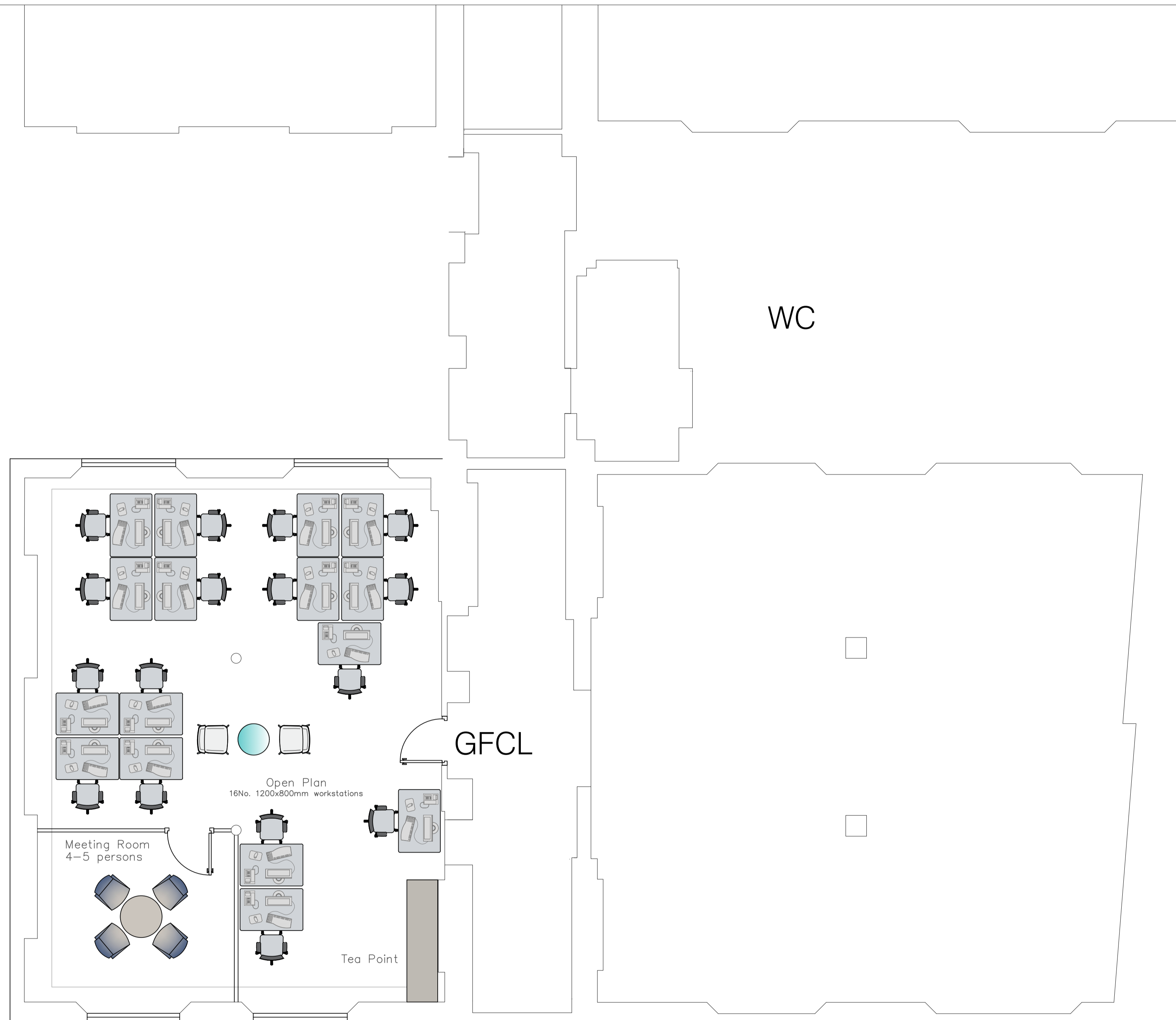

Proposed General Arrangement Plan
 Ground Floor
 Desk 1200mm x 800mm

Rev.	Description	Date
-	Proposed layout	11.06.26

PROPOSED

Address:
 6 Lloyds Avenue
 London

Project:
 Private Client

Drawing title:
 Ground Floor - 01

Scale: 1:50 @A3
 Project No: 00004
 Drawing No: 004.01.01



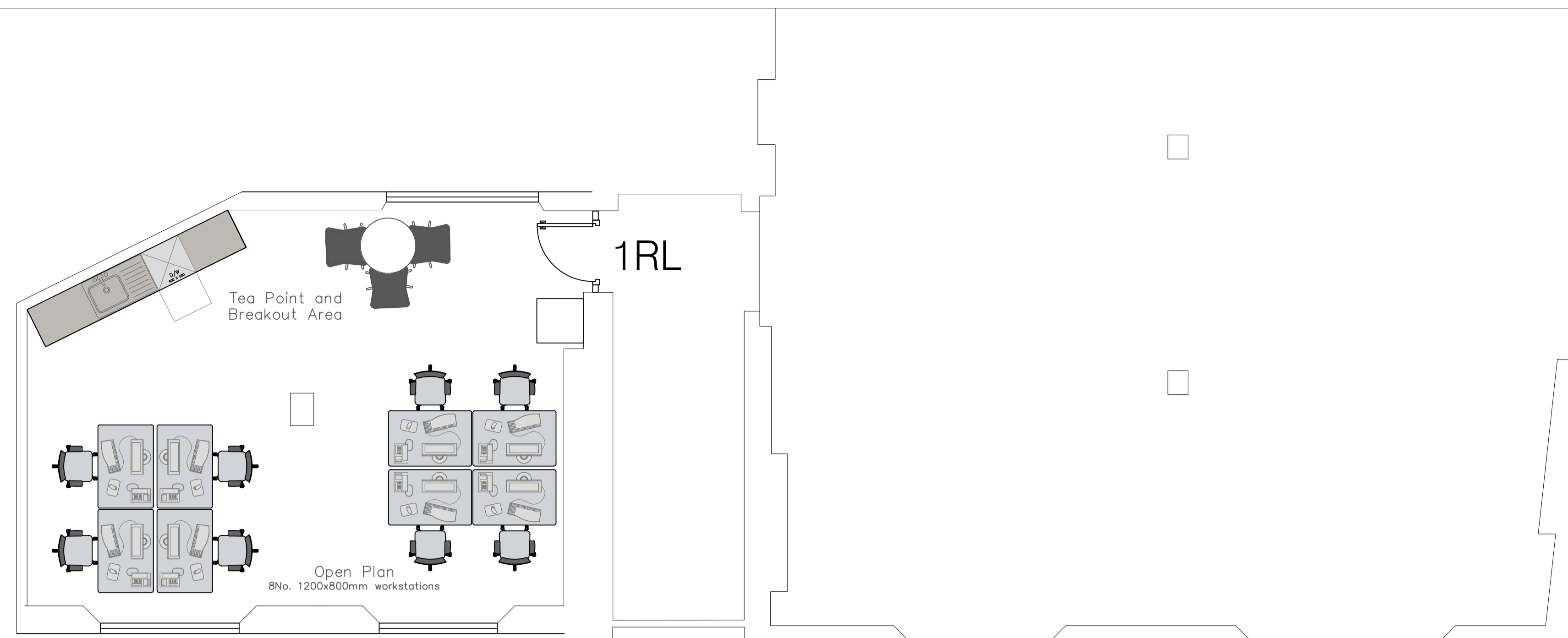

Proposed General Arrangement Plan
First Floor
Desk 1200mm x 800mm

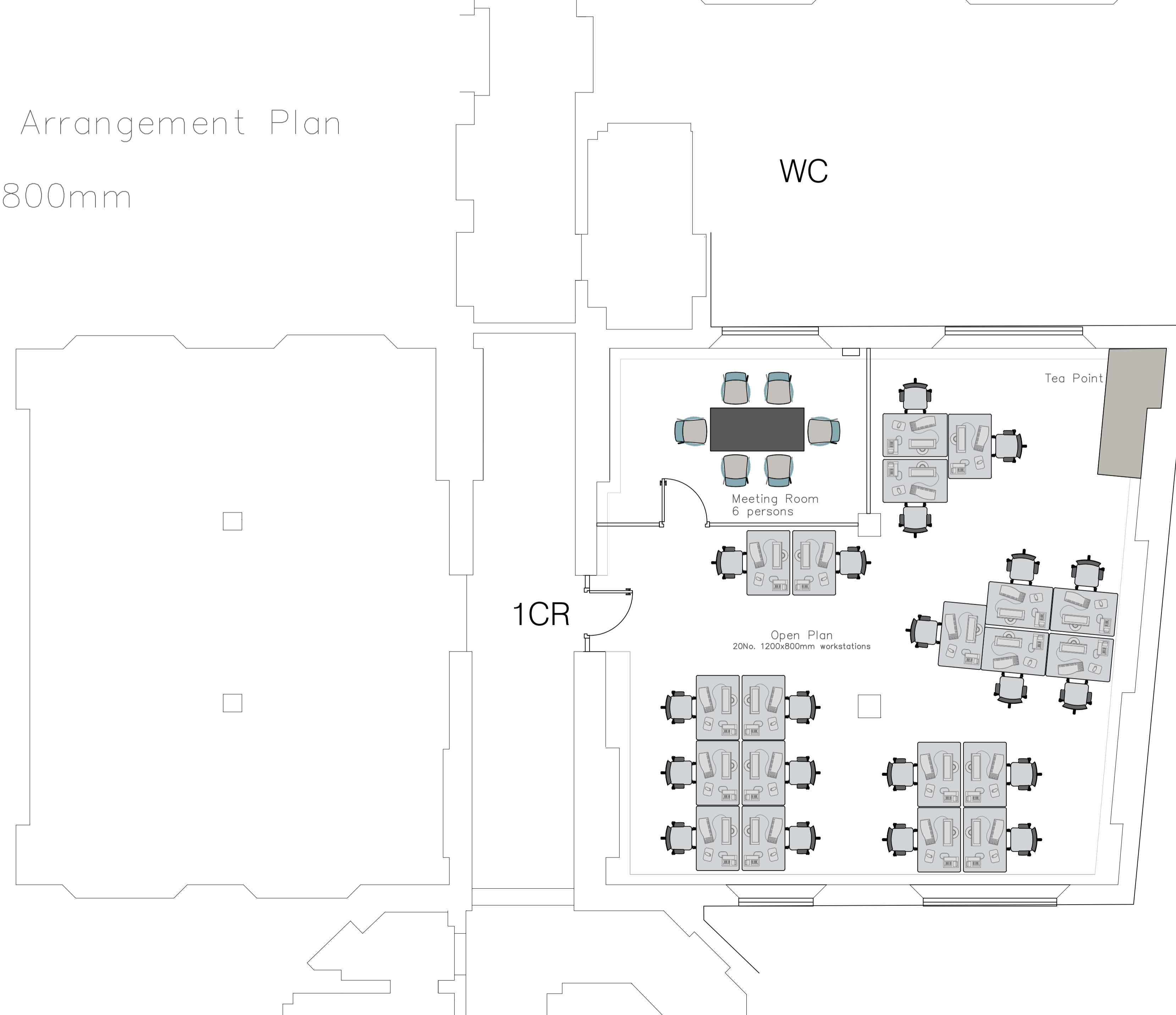

NOTE: STOCK PROJECT
THIS ELECTRONIC INFORMATION IS
CONFIDENTIAL AND THE COPY OF
STOCK PROJECTS, NO USE IS
PERMITTED OF IT OTHER THAN
BY THE INTENDED RECIPIENT FOR
PROPER PURPOSE NOR
SHALL IT BE DISCLOSED OR
PASSED ON TO ANY
OTHER PARTY IN ANY FORM IN
WHOLE OR IN PART
WITHOUT OUR EXPRESS
PERMISSION.
THE DATA IS SUPPLIED
ELECTRONICALLY FOR
CONVENIENCE ONLY. THE ORIGINAL
INFORMATION IS THE HARD COPY
WHICH WILL BE SUPPLIED ON
REQUEST.
NO DIMENSIONS OR OTHER
INFORMATION SHOULD BE INFERRED
FROM THE ELECTRONIC DATA
UNLESS SPECIFICALLY SHOWN ON
THE HARD
COPY. WE ACCEPT NO LIABILITY
FOR ANY EFFECT THAT THE
TRANSMISSION OR USE OF THIS
DATA MAY HAVE ON ANY
COMPUTER OR SYSTEM WHETHER IN
RELATION TO ANY DEFECT, VIRUS
OR ANY OTHER MATTER. YOUR
RECEIPT OF THIS INFORMATION
AND OPENING OF THE FILES
CONSTITUTES ACCEPTANCE OF
THESE TERMS.

— Proposed layout 11.06.26
Rev: | Description Date

PROPOSED

Address:
6 Lloyds Avenue
London

Project:
Private Client

Drawing title:
First Floor - 01

Scale: 1:50 @A3
Project No: 00004
Drawing No: 004.02.01





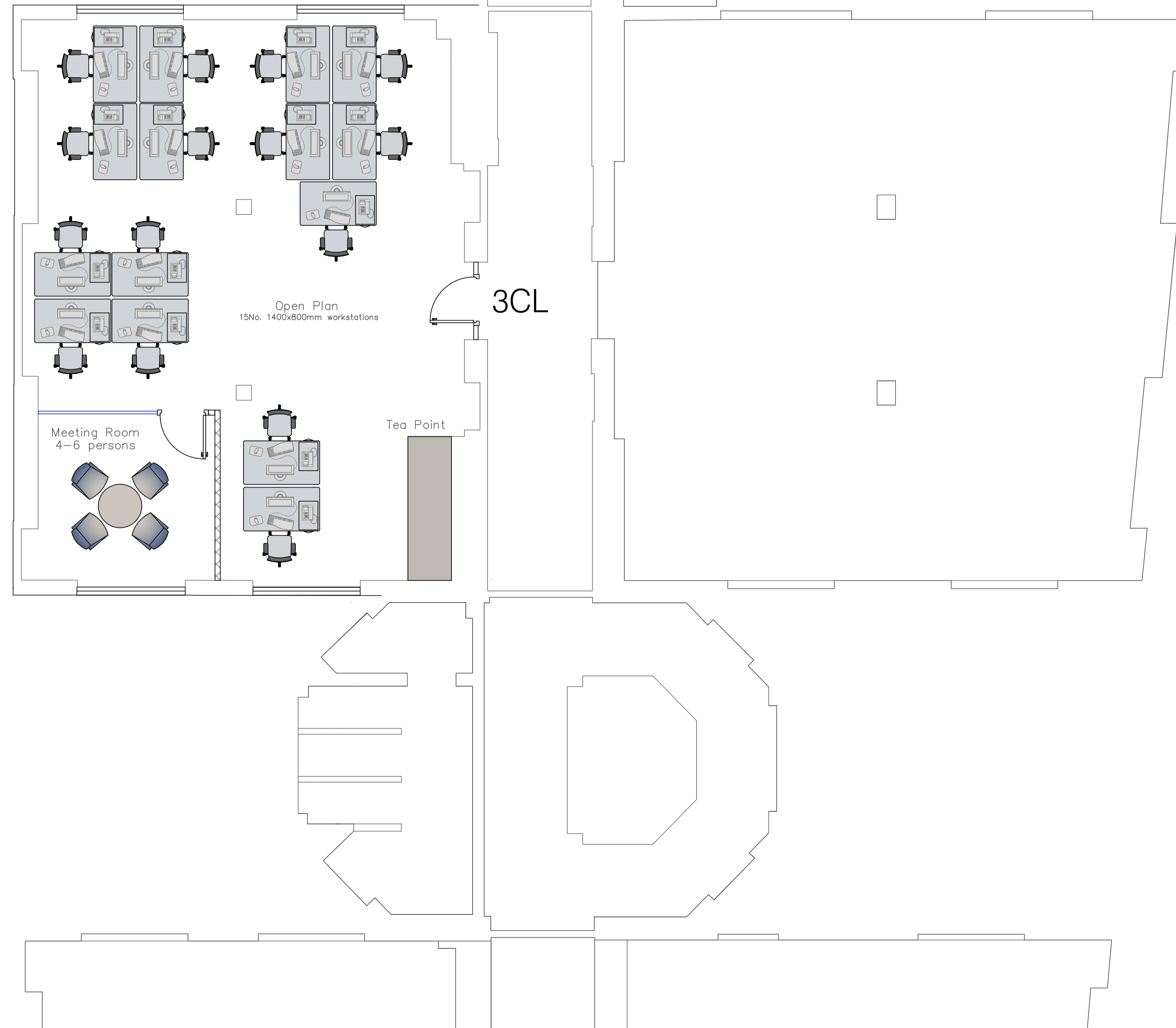

Proposed General Arrangement Plan
 Third Floor
 Desk 1400mm x 800mm



NOTE: STOCK PROJECT
 THIS ELECTRONIC INFORMATION IS
 CONFIDENTIAL AND THE COPY OF
 STOCK PROJECTS, NO USE IS
 PERMITTED OF IT OTHER THAN
 BY THE INTENDED RECIPIENT FOR
 PROPER PURPOSE NOR
 SHALL IT BE DISCLOSED OR
 PASSED ON TO ANY
 OTHER PARTY IN ANY FORM IN
 WHOLE OR IN PART
 WITHOUT OUR EXPRESS
 PERMISSION.
 THE DATA IS SUPPLIED
 ELECTRONICALLY FOR
 CONVENIENCE ONLY. THE ORIGINAL
 INFORMATION IS THE HARD COPY
 WHICH WILL BE SUPPLIED ON
 REQUEST.
 NO DIMENSIONS OR OTHER
 INFORMATION SHOULD BE INFERRED
 FROM THE ELECTRONIC DATA
 UNLESS SPECIFICALLY SHOWN ON
 THE HARD
 COPY. WE ACCEPT NO LIABILITY
 FOR ANY EFFECT THAT THE
 TRANSMISSION OR USE OF THIS
 DATA MAY HAVE ON ANY
 COMPUTER OR SYSTEM WHETHER IN
 RELATION TO ANY DEFECT, VIRUS
 OR ANY OTHER MATTER. YOUR
 RECEIPT OF THIS INFORMATION
 AND OPENING OF THE FILES
 CONSTITUTES ACCEPTANCE OF
 THESE TERMS.

GENERAL ARRANGEMENT LEGEND:

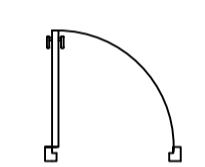
-  EXISTING WALL
-  EXISTING GLAZING
-  NEW 100mm PARTITION
-  NEW GLAZING
-  NEW SOLID DOOR

—	Proposed layout	11.06.26
Rev.	Description	Date

P R O P O S E D

Address:
 6 Lloyds Avenue
 London

Project:
 Private Client

Drawing title:
 Third Floor - 02

Scale: 1:50 @A3
 Project No: 00004
 Drawing No: 004.04.02



NOTE: STOCK PROJECT
 THIS ELECTRONIC INFORMATION IS
 CONFIDENTIAL AND THE COPY OF
 STOCK PROJECTS, NO USE IS
 PERMITTED OF IT OTHER THAN
 BY THE INTENDED RECIPIENT FOR
 PROPER PURPOSE NOR
 SHALL IT BE DISCLOSED OR
 PASSED ON TO ANY
 OTHER PARTY IN ANY FORM IN
 WHOLE OR IN PART
 WITHOUT OUR EXPRESS
 PERMISSION.
 THE DATA IS SUPPLIED
 ELECTRONICALLY FOR
 CONVENIENCE ONLY. THE ORIGINAL
 INFORMATION IS THE HARD COPY
 WHICH WILL BE SUPPLIED ON
 REQUEST.
 NO DIMENSIONS OR OTHER
 INFORMATION SHOULD BE INFERRED
 FROM THE ELECTRONIC DATA
 UNLESS SPECIFICALLY SHOWN ON
 THE HARD
 COPY. WE ACCEPT NO LIABILITY
 FOR ANY EFFECT THAT THE
 TRANSMISSION OR USE OF THIS
 DATA MAY HAVE ON ANY
 COMPUTER OR SYSTEM WHETHER IN
 RELATION TO ANY DEFECT, VIRUS
 OR ANY OTHER MATTER. YOUR
 RECEIPT OF THIS INFORMATION
 AND OPENING OF THE FILES
 CONSTITUTES ACCEPTANCE OF
 THESE TERMS.

Proposed General Arrangement Plan
 Fourth Floor
 Desk 1200mm x 800mm

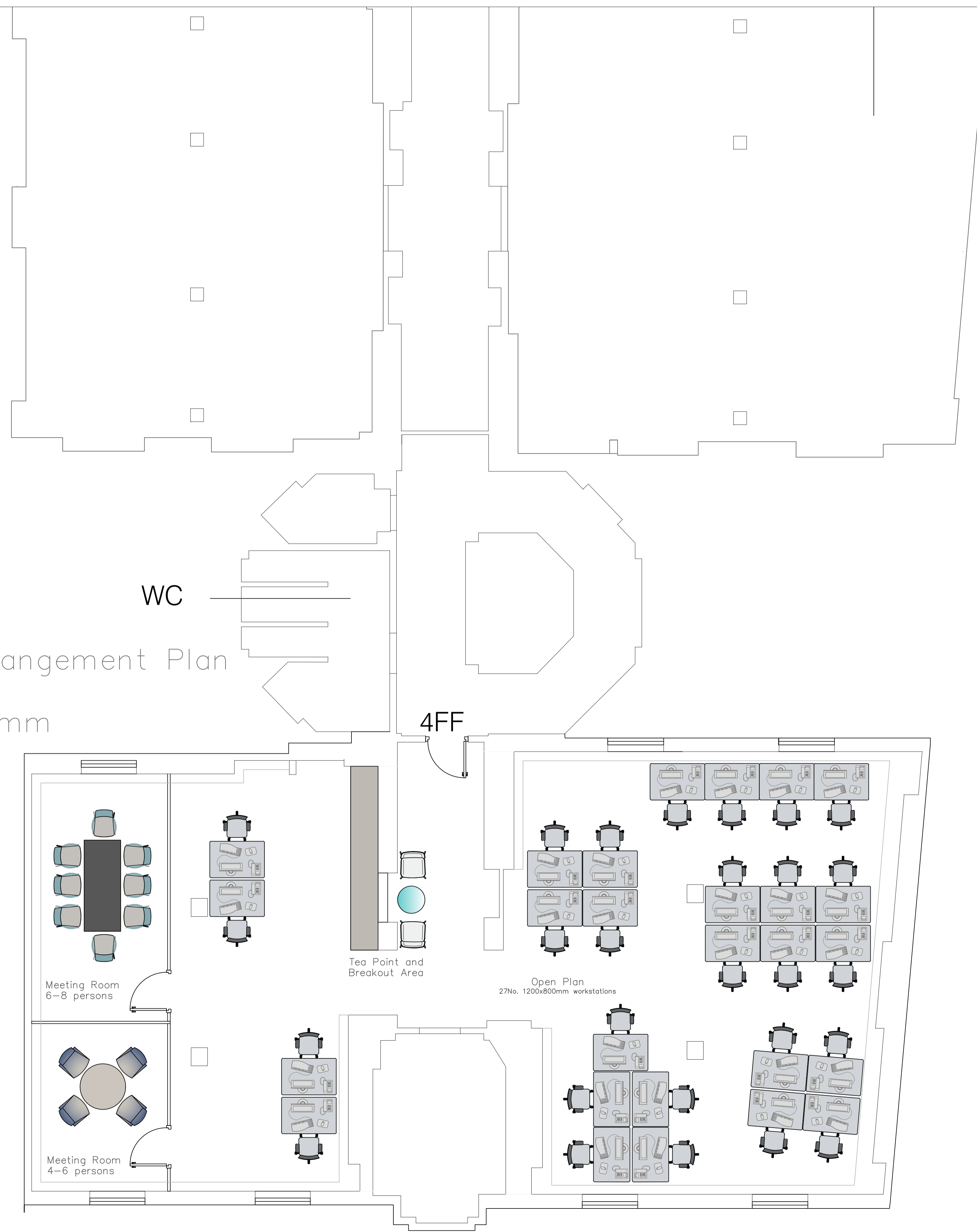

— Proposed layout 11.06.26
 Rev: | Description Date

PROPOSED

Address:
 6 Lloyds Avenue
 London

Project:
 Private Client

Drawing title:
 Fourth Floor - 01

Scale: 1:50 @A3
 Project No: 00004
 Drawing No: 004.05.01





Proposed General Arrangement Plan
Fifth Floor
Desk 1200mm x 800mm

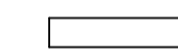
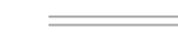

NOTE: STOCK PROJECT
THIS ELECTRONIC INFORMATION IS CONFIDENTIAL AND THE COPY OF STOCK PROJECTS, NO USE IS PERMITTED OF IT OTHER THAN BY THE INTENDED RECIPIENT FOR PROPER PURPOSE NOR SHALL IT BE DISCLOSED OR PASSED ON TO ANY OTHER PARTY IN ANY FORM IN WHOLE OR IN PART WITHOUT OUR EXPRESS PERMISSION. THE DATA IS SUPPLIED ELECTRONICALLY FOR CONVENIENCE ONLY. THE ORIGINAL INFORMATION IS THE HARD COPY WHICH WILL BE SUPPLIED ON REQUEST. NO DIMENSIONS OR OTHER INFORMATION SHOULD BE INFERRED FROM THE ELECTRONIC DATA UNLESS SPECIFICALLY SHOWN ON THE HARD COPY. WE ACCEPT NO LIABILITY FOR ANY EFFECT THAT THE TRANSMISSION OR USE OF THIS DATA MAY HAVE ON ANY COMPUTER OR SYSTEM WHETHER IN RELATION TO ANY DEFECT, VIRUS OR ANY OTHER MATTER. YOUR RECEIPT OF THIS INFORMATION AND OPENING OF THE FILES CONSTITUTES ACCEPTANCE OF THESE TERMS.

GENERAL ARRANGEMENT LEGEND:

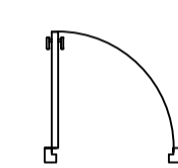
-  EXISTING WALL
-  EXISTING GLAZING
-  NEW 100mm PARTITION
-  NEW GLAZING
-  NEW SOLID DOOR

— Proposed layout 11.06.26
Rev: | Description Date

P R O P O S E D

Address:
6 Lloyds Avenue
London

Project:
Private Client

Drawing title:
Fifth Floor – 01

Scale: 1:50 @A3
Project No: 00004
Drawing No: 004.06.01

