

RUBIX

30 COLLEMAN
STREET EC2

Refurbished, fully fitted space available in a prime City Core

30 Coleman Street offers high-quality space in a prime City Core location. The reception and end-of-journey facilities have been fully refurbished, creating an elevated arrival experience that blends design with comfort and functionality.

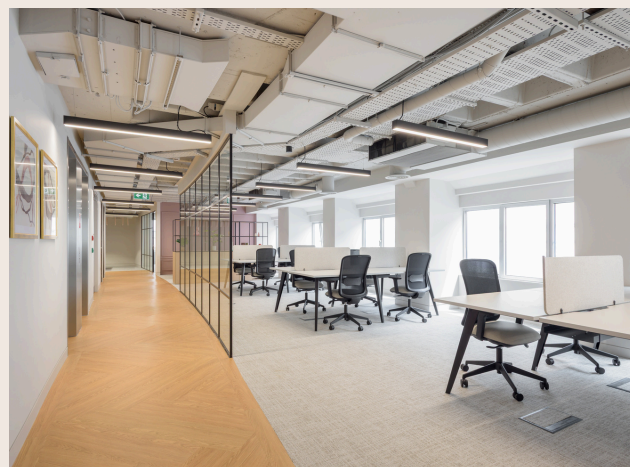

AMENITIES



BIKE & SHOWER FACILITIES



AIR CONDITIONING



NEW LED LIGHTING



MANNED RECEPTION



FIBRE INSTALLED

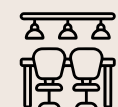

FULLY FITTED OFFICE SPACE



30 OPEN PLAN DESKS



LIFTS



NEWLY REFURBISHED OFFICE SPACE

THE CITY

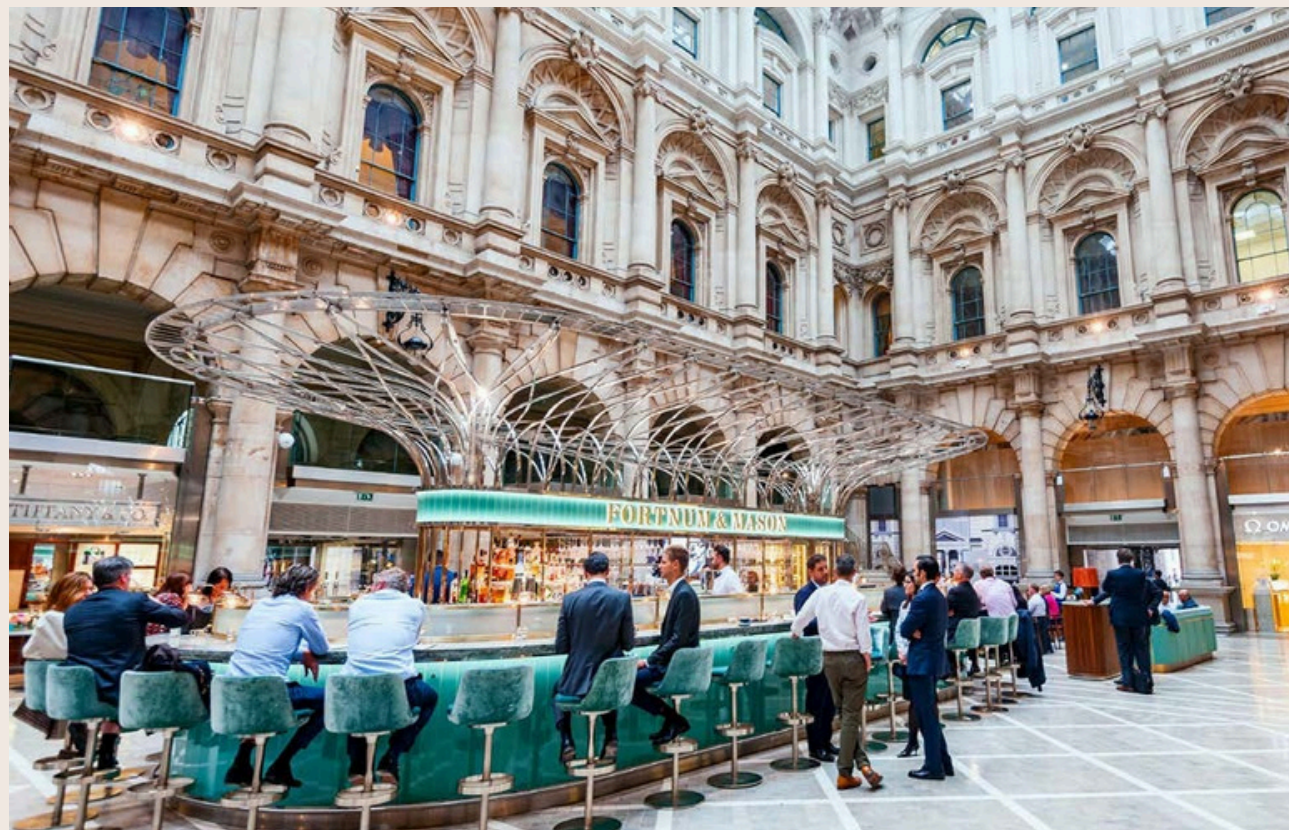

AVAILABILITY

FLOOR	SQ M	SQ FT	RENT/PSF	S.C/PSF	RATES/PSF	TOTAL/MONTH
4TH	334.72	3,603	£75.00	£18.51	£17.27	£33,261.69

TERMS: NEW LEASE DIRECT FROM THE LANDLORD

LOCATION



TALK TO US

Viewing is strictly by prior appointment with Rubix.

Harry Radcliffe

E: harry@rubix.london
M: +44(0)7796217354

Oliver Hawking

E: oliver@rubix.london
M: +44(0)7714 145970

Disclaimer - Rubix Real Estate Ltd for themselves and for the vendors or lessors of this property whose agents they are given notice that:- (1) The particulars are set out as a general outline for the guidance of the intending purchasers and do not constitute part of an offer or contract; (2) All descriptions, dimensions, references to condition and necessary permissions for use and occupation and other details are given without responsibility and any intending purchasers should not rely on them as standards or representations of fact but must satisfy themselves by inspection or otherwise as to the correctness of each of them; (3) No persons in the employment of Rubix Real Estate Ltd has any authority to make or give any representation or warranty whatsoever in relation to this property.